

Topic 1: Introduction to Nursing

Topic 2: Acute Care Nursing

Topic 3: Chronic Care Nursing

Topic 4: Specialised Nursing

HLT33115 – Health Services Assistance Units

• Topic 1: Introduction to Nursing

Unit 1 – CHCDIV001 – Work with diverse people

Unit 2 – CHCCOM005 – Communicate and work in health or community services

Unit 3 – HLTAAP001 – Recognise healthy body systems

Unit 4 – HLTWHS001 – Participate in workplace health and safety

Unit 5 – HLTINF001 – Comply with infection prevention and control procedures

Unit 6 – BSBMED301 – Interpret and apply medical terminology

Unit 7 – BSBWOR301 – Organise personal work priorities and development

• Topic 2: Acute Care Nursing (+ Unit 1-7)

Unit 8 – HLTAID003 – Provide First Aid

Unit 9 – HTAIN002 – Provide non-client contact support in an acute care environment

• Topic 3: Chronic Care Nursing (+Unit 1-7)

Unit 10 – CHCCCS015 – Provide individualised support

Unit 11 – CHCCCS012 – Prepare and make beds

• Topic 4: Specialised Nursing (Aged, Youth, Paeds)

Unit 12 – CHCPRP005 Engage with professionals & the health system

Unit 13 – CHCCCS020 – Respond effectively to behaviours of concern

Unit 14 – CHCCCS002 – Assist with movement

Unit 15 – CHCCCS026 – Transport individuals

Unit 16 – CHCAGE001 – Facilitate empowerment of older people

Unit 17 – CHCAGE005 – Support people living with dementia

Work Preparation:

Students in Pathway 2/3 will be given the opportunity to complete work preparation. This will be incorporated within the general learning timeline for the course. Concepts explored include:

- Workplace arrangements and behaviours
- Workplace communication and numeracy
- Job seeking and application



Work Placements:

These are subject to availability, with preference going to students in the Pathway 3 and 2 programs.

PATHWAY 1:

Diversional Activities with Clients visiting Hobart College

PATHWAY 2:

Diversional Activities with Clients visiting Hobart College

- Placement at Aged Care Facilities or Royal Hobart Hospital - Health Information Management Services for 5-6 days in June - September

PATHWAY 3:

Diversional Activities with Clients visiting Hobart College

- **Paediatric Placement** for one week in March
- **Youth Placement** for two days in May
- **Aged Care Placement** for one week in August

Expectations of students prior to placement:

- Complete Police Check or WWVP

Introduction to Nursing

HLT33115 – Health Services Assistance

2019

The Tas Secondary Colleges RTO, code 60100, is the registered training organisation for these qualifications.



Contacts

Matt.eyles@education.tas.gov.au

Anita.johansson-wong@education.tas.gov.au

P: 6220 3133



Tasmanian
Secondary
Colleges
RTO Code 60100

Visit

teachingprojects.weebly.com/introduction-to-nursing.html

Course Purpose

The **Introduction to Nursing** course helps to establish a quality health services workforce through positive reciprocal relationships with industry and by implementing practical-based approaches which:

- 1) provide students with the foundation skills to enter the health services industry,
- 2) inspire and excite students to enter the health service industry, and
- 3) provide students with opportunities and pathways into further education and work in the health services industry.

The course maps units from **HLT33115-Certificate III in Health Services Assistance**. Students complete 4 thematic topics through three different pathways. They can receive statements of attainment for any units completed or the full qualification over two years. Working in the simulated hospital, along with work placements within the relevant health field this course sets students up for future employment or studies within nursing or the broader health services.

Year 1 (one line)

Introduction to Nursing (Pathway 1)

Ideal for Year 11 students unsure if this is for them, or on an ATAR pathway in Year 12

For Year 11 or Year 12 students, this is a **ONE** line face-to-face course in the simulated hospital with a range of online activities that will give students a 'taster' of the health services. Students will:

- Complete aspects of Topic 1, 2 and 3 for the Introduction to Nursing course
- Complete 6 of the 15 units from the Certificate III in Health Services Assistance (Unit 2,3,4,6,8,10), including First Aid.
- Participate in visits running diversional therapy activities for clients from a local aged care facility.
- Gain up to 21 TCE Points
- **Gain access to Pathway 3 for Year 12 upon application**

OR

Introduction to Nursing (Pathway 2)

Ideal for Year 11 students who aim to gain the full Certificate III over two years OR Year 12 students aiming to pathway into vocational-based courses.

For Year 11 or Year 12 students, this is a **TWO** line face-to-face course in the simulated hospital with practical placements at health facilities and a range of online activities. It will give students an in-depth experience of the health services. They will:

- Complete all of Topics 1, 2 and 3 of the Introduction to Nursing course
- Complete 11 of 15 units from the Certificate III in Health Services Assistant (Unit 1-11), including First Aid.
- Complete a small work placement at a health facility or participate in visits running diversional therapy activities for clients from a local aged care facility.
- Complete work preparation including resume development and job applications
- Gain up to 36 TCE Points
- **Gain direct access to Pathway 3 for Year 12 or apply to complete the Pathway 3 accelerated course (only available to Year 12 students)**

Year 1 (two lines)

Advanced Introduction to Nursing (Pathway 3)

Ideal for Year 12 students wanting to deepen their knowledge and gain the full Certificate III in Health Services Assistance. It is mapped to allow students to complete ATAR subjects as well.

Following on from Pathway 1 or 2, this is a **ONE** line face-to-face course in the simulated hospital with a large online component. It allows students to synthesise learnings to the specialised setting. They will:

- Complete the remaining units (unit 12-17) of Topic 4: Specialised Nursing, exploring paediatrics, maternity, youth mental health, disability care and aged care, and be awarded the full qualification for the Certificate III in Health Services Assistance (**NOTE: PATHWAY 1 students will need to make up units (1,5,7,9,11) missed from previous year in their own time**)*
- Complete a small work placement at child and family centres, youth support and aged care facilities + diversional therapy activities for clients from a local aged care facility.
- Gain up to 15 TCE Points
- Be given the option of completing a range of other units regarding dementia care and supporting elderly clients

Note: An option for non-ATAR students to complete a School Based Traineeship through ACSA can be done through discussion.

Year 2 (one line)

HOBART COLLEGE HOSPITAL - LAYOUT

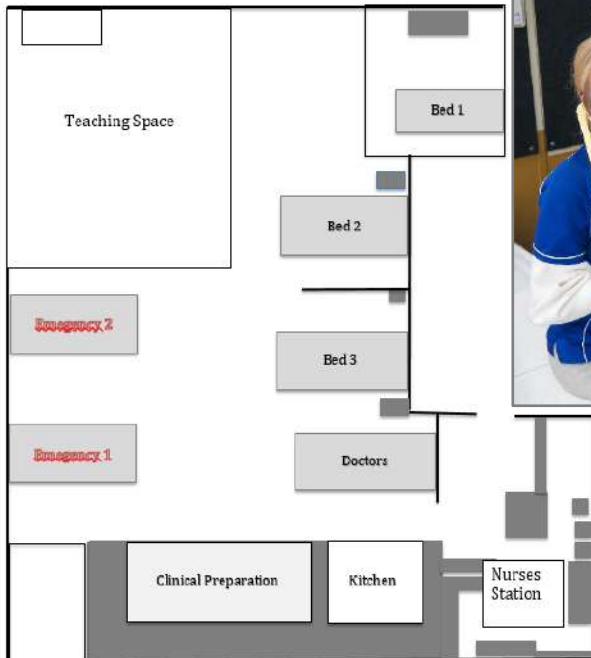

AFTER COLLEGE

- Study the *Certificate III in Individual Support* to become a Disability Carer or Aged Carer at TAFE or HERCs with credit transfer for some units.
- Use understandings to study Enrolled Nursing at TAFE or HERCs, or Registered Nursing or other health courses like paramedicine at university, (NB: an ATAR score is required for university entrance) or University College to complete an Associate Degree.
- Work in health areas as a support worker, food services worker, orderly or ward clerk.